



F54/121 - IMC Vulture 904 Single Trough Food Waste Disposer - 3 Phase [4 wire] - W 551 mm - 1.1 kW

Reliable, efficient, safe and easy to operate, the 904 Single Trough Waste Disposer allows operators to quickly and effectively remove waste, to create a safer and cleaner kitchen.

- ✔ Fast and efficient disposal of up to 500kg of food waste per hour.
- ✔ With single trough - ideal for high-volume operations.
- ✔ Handles up to 1000 covers per sitting - ideal for large kitchens.
- ✔ Manually reversible motor to extend operational life.
- ✔ For medium waste (plate waste, vegetables and peelings, meat and fish scraps).
- ✔ Suitable for large kitchens with three-phase power supply.
- ✔ For integration into troughing system.

Specifications

Summary

Brand	IMC
Range	Vulture
Series	04 Series
Power Type	Electric
Unit Type	Welded into troughing system
Available in UK Only	No
UK Warranty	2 Years Parts and Labour Warranty
Export Warranty	Contact your local dealer
Mounting	Welded into troughing system
GTIN	5056105199373

Power and Performance

Total Power kW	1.1
HP	1.5
IP Rating	IP55

Key Specifications

Operator Safety	Interlocks
WRAS Approved	WRAS Compliant [if cistern fed]

Capacity

Type of Waste	Medium waste
Covers Per Sitting	1000
Capacity Kg per Hour	500

Weights and Dimensions

Unit Height (External) mm	800
Unit Width (External) mm	551
Unit Depth (External) mm	302
Net Weight Kg	54.5

Supply Connections

Requires Installation	Yes
Requires Electrical Supply	Yes
UK 3 Pin Plug	No
Requires Hardwiring	Yes
Electrical Supply Rating Watts	1100
Three Phase Amps	2.8
Three Phase Voltage	400
Water Supplied From	Mains or storage cistern
Water Connection Pressure Bar	0.4
Drain Connection	2" BSP threaded flange, connected to 54mm piping;
Water Connection	15mm

Shipping

Packed Weight Kg	59.95
Packed Height cm	104
Packed Width cm	64
Packed Depth cm	49

Available Options

REMOTE CONTROL BOX

S55/016

904 REMOTE CONTROL BOX

MAG CUTLERY SAVER

VS167

700/800/904/904X MAGNETIC CUTLERY SAVER

WATER FLOW CONTROL

VS353

904 WATER FLOW CONTROL

Technical Picture

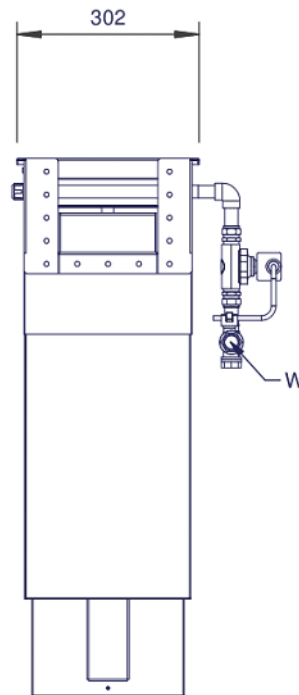
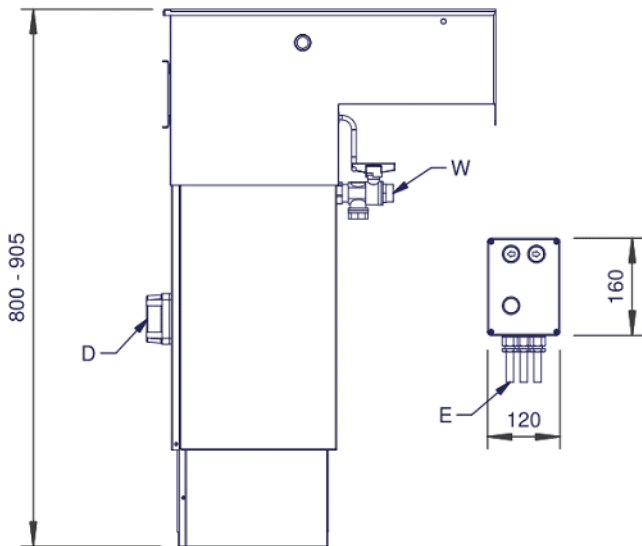
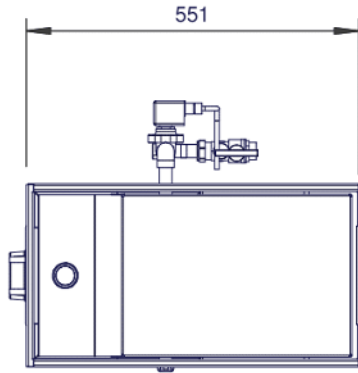

Lincat Limited

Whisby Road,
Lincoln, LN6 3QZ,
United Kingdom

Company No: 2175448

A member company of



Customer Care

Tel: +44 1522 875500
Email: care@lincat.co.uk

Export Customers

Tel: +44 1522 875536
Email: export@lincat.co.uk

Opening Hours

Monday – Friday:
8.30am – 5pm