

Technical Specifications

Model	OE7405	OE7406
Overall height (mm)	450	450
Height to hob (mm)	300	300
Width (mm)	600	900
Depth (mm)	737	737
Electrical power rating (kW)	11.2	2 x 8.25
Electrical requirements	3 phase	3 phase
Voltage	400	400
Amps per phase	16.2/16.2/16.2	24/24/24
Water inlet connection	1/2" BSPT	1/2" BSPT
Water overflow diameter (mm)	22	22
Weight (kg)	44	58

Electric Chargrills



OE7405

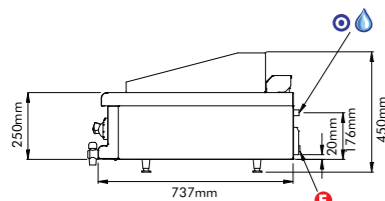
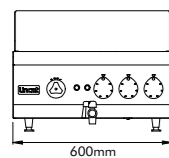
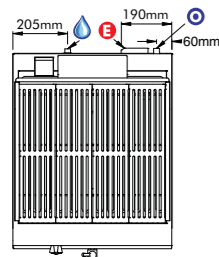

OE7406

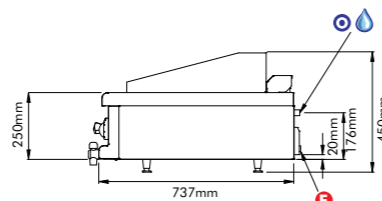
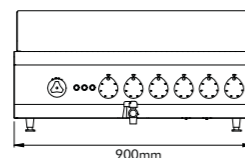
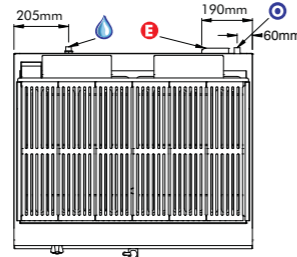

KEY

- E Electrical Connection
- O Overflow
- W Water Connection



You can choose Lincat products with confidence. All products in this leaflet are backed by the reassurance of a comprehensive UK two-year parts and labour warranty.

QUALITY GUARANTEED



**Lincat Limited, Whisby Road,
Lincoln LN6 3QZ,
United Kingdom**

UK Sales Tel: 01522 875500 UK Spares Tel: 01522 875510 UK General Tel: 01522 875555
UK Fax: 01522 875530 International Sales Tel: +44 1522 503250 International Fax: +44 1522 875530
Website: www.lincat.co.uk UK Sales e-mail: sales@lincat.co.uk International Sales e-mail: export@lincat.co.uk

Lincat's Opus 700 electric chargrills are designed for fast cooking and maximum output whilst still delivering the authentic taste and branded appearance of genuine chargrilled food.

Both models are supplied as counter-top units but can be mounted on optional floor stands.



OE7406

With optional floor stand (OA7948)



Heavy-duty branding grids



High powered heating element



OE7405

With optional floor stand (OA7947)



Funnel for manual water fill



Lift and park hinged element

Features

- Removable, durable, segmented cast iron grids impart attractive branding marks to food
- Independently controlled multiple heat zones (3 in OE7405 and 6 in OE7406) for maximum versatility
- High power delivers fast cooking and maximum output
- Controlled flaring gives that distinctive chargrilled flavour
- Hinging, interlocked elements and integral water bath makes cleaning easier
- Water bath provides humidity, keeping food succulent and reducing shrinkage
- Large cooking area
- Plumbed to water supply for quick and easy filling of water bath with alternative manual-fill facility
- Front drainage tap
- High temperature safety cut-out for protection if water bath runs dry

Inclusive Accessories

- Grid cleaning tool
- Branding iron lifting tool

Optional Accessories

- **OA7947** – Floor stand for model OE7405
- **OA7948** – Floor stand for model OE7406
- **OA7949** – Griddle plate

Essential Facts & Figures

Model	Power (kW)	Width (mm)	Branding grid cooking area (mm)	Steaks per hour*
OE7405	11.2	600	552 x 525	75
OE7406	2 x 8.25	900	828 x 525	110

* Typical outputs for 8oz (225g) sirloin steaks medium cooked